



perfera



# The perfect solution for a comfortable home



**NEW** Perfera  
wall mounted unit



Find out more at [www.daikin.eu](http://www.daikin.eu)



# Perfera

Great looks that deliver  
even smoother air flow

# Perfera wall mounted unit

# Designed for comfort

## Perfera makes cool living and working a breeze

Whatever the weather's doing outside, inside you want optimum comfort throughout the day. Like a cool summer breeze, Perfera instinctively knows how to keep the room temperature in your living or working space at the ideal level, so that you and those around you can get on with relaxing, enjoying yourselves – and being productive. The stylishly designed front panel, whisper-quiet operation and the perfect circulation of cooled or heated air help make each room the place you – and everyone – always want to be.

## Perfera: a stylish combination of heating and cooling

Perfera's climate control pedigree offers you the very best in heating and cooling options. Designed to blend effortlessly into any decor, the new Perfera now has 'heat boost': an ingenious feature that takes the chill off the air in an instant.

## Features of the new Perfera

- › Seasonal efficiency values up to A+++ in cooling and heating.
- › Heat boost quickly heats up your home when starting up your air conditioner. Set temperature is reached 14% faster than a regular air conditioner (pair only).
- › Using electrons to trigger chemical reactions with air borne particles, the Flash Streamer breaks down allergens such as pollen and fungal allergens and removes bothersome odours providing a better, cleaner air.
- › Silver allergen removal and air purifying filter captures allergens such as pollen to ensure a steady supply of clean air.
- › Titanium apatite deodorising filter decomposes bothersome odours of for example tobacco and pets
- › Voice command via Amazon Alexa or Google Assistant to control main functions such as set point, operation mode, fan speed, etc.
- › Quiet operation: down to 19dBA sound pressure level.
- › 3-D air flow combines vertical and horizontal auto swing to circulate a stream of warm or cool air right to the corners of even large spaces.
- › 2-area motion detection sensor: air flow is sent to a zone other than where the person is located at that moment. If no people are detected, the unit will automatically switch over to the energy-efficient setting.



# Intelligent

## Powerful - Quiet

### 3-D Air flow

By pressing the buttons on the remote control, this function combines vertical and horizontal auto-swing to circulate a stream of cool/warm air right to the corners of even large spaces.

### Silent operation

Perfera uses a **specially designed fan** that optimises airflow and creates high energy efficiency at low sound levels. For even higher energy efficiency, Daikin has also designed a new fan that fits snugly into Perfera's compact dimensions.

Together, the fan and heat exchanger produce top energy performance, yet operate at a sound level that is practically inaudible. Shhh!

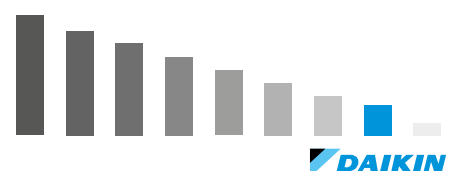



## Air quality

### Flash streamer/ titanium apatite deodorising filter

Flash streamer: using electrons to trigger chemical reactions with airborne particles, the Flash Streamer removes allergens such as pollen and fungal allergens, eliminating unpleasant odours and providing better, cleaner air.

And the titanium apatite deodorising filter works hard to combat smells such as tobacco smoke and pets.

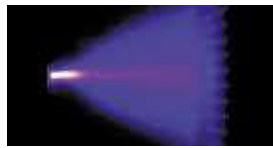

FLASH STREAMER

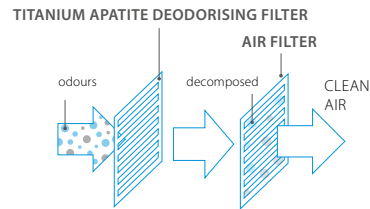

### Silver allergen removal filter

The Silver allergen removal and air purifying filter is your solution, because it captures allergens such as pollen to ensure a steady supply of clean air.

## Unique heating feature



### Heat boost

Heat boost quickly heats up your home when starting up your air conditioner. Set temperature is reached 14% faster\* than a regular air conditioner (pair only)



\*Heat Plus test condition: 50 class, outdoor temperature 2°C - Indoor temperature 10°C, R/C setting: 23°C

# Technology meets design for the ideal climate solution

## Sheer bliss

While the outside of the new Perfera is all about eye-catching design and style, it's the inside that creates the perfect indoor climate. And once Perfera has generated the exact air temperature you set, the wider flap ensures a stronger, more consistent flow of air that is distributed evenly thanks to the clever 3D airflow. The Perfera has been redesigned with more compact dimensions to reduce the width of the unit by more than 30 mm. The result is a wall mounted unit that is so discreet it is almost like a piece of art – a masterpiece, you might say!

## Wide flap

Reduced dimensions

Enables you to direct hot or cool air in the exact direction you want.



The side of the panel emphasises the strong airflow of the unit





# Let's talk about Energy efficiency

## Energy label

The enhanced design of the Perfera boosts energy efficiency even further compared with previous models. It boasts a seasonal energy efficiency ratio (SEER) of up to 8.65 and a seasonal coefficient of performance (SCOP) of up to 5.10. This gives the Perfera **best-in-class performance**, with seasonal efficiency values up to A+++ in cooling and heating resulting in low running costs.

The Perfera is an energy-saving winner from every angle.

up to  
**A+++**  
in cooling

up to  
**A+++**  
in heating

# Sleep comfortable

with the new Perfera



## Night set mode

To help you sleep more comfortably, Daikin night set mode prevents overheating or overcooling during the night. If the timer is switched on, the unit will automatically set the temperature 2°C cooler when heating and 0.5°C warmer when cooling. This keeps the ambient temperature nice and even – and prevents rapid changes that could disturb your sleep.



## Outdoor silent operation

To ensure a quiet environment for the neighbourhood the user can lower the operation sound of the outdoor unit by 3 dB(A) via remote control.



## Econo mode

The Econo mode reduces power consumption and prevents overloading your electrical circuits when other household appliances are also in use. By activating the Econo mode, maximum operating power and energy consumption are reduced by around 30% during start-up.



## 2 area motion detection sensor

Air flow is sent to a zone other than where the person is located at that moment. Detection is done in 2 directions: left and right. If no people are detected, the unit will automatically switch over to the energy-efficient setting.



# Application



## Extended operation range

The new Perfera is suitable for all climates, even withstanding severe weather conditions with an operation range down to -20°C and up to 50°C.



## Pair or Multi connection

The Perfera can be used in a single room set-up, with one indoor unit connected to one outdoor unit, or in a multiple room application with a maximum of **five indoor units connected to one outdoor unit**. The outdoor unit can be installed on the roof, terrace or against an outside wall.

## Wide product range

- › The new Perfera capacity has a wide product range, including a 15 class for multi applications
- › It offers 8 capacities: 15, 20, 25, 35, 42, 50, 60 and 71 class





# Control your climate from anywhere

## Flexible control

The indoor unit is easy to control with the infrared remote control supplied as standard. It also comes equipped with a weekly timer, enabling you to programme a seven-day schedule with four different operations per day.

You can also manage Perfera, using your smartphone. Simply connect to Wi-Fi and download the [Daikin Residential Controller app](#) to begin creating the perfectly comfortable climate for your home.

**NEW** Control your system and enjoy maximum comfort, just by using your voice. Via Amazon Alexa or Google Assistant you can control main functions such as temperature set point, operation mode, fan speed, and much more!

### Your benefits

- › Access to various features for controlling your internal climate
- › Manage the temperature, operating mode, air purification and fans with the interactive thermostat
- › Create different operating schedules and modes
- › Monitor energy consumption

## Intuitive online and voice control

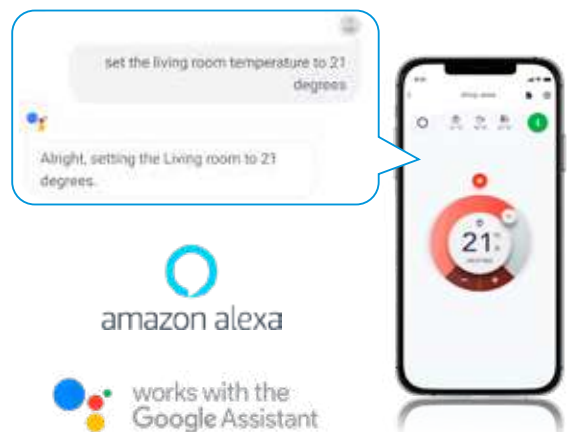

# Perfera for optimal comfort thanks to high energy efficiencies

| Efficiency data                           |                           | C/FTXM + RXM | CTXM15R | 20R + 20R      | 25R + 25R      | 35R + 35R      | 42R + 42R      | 50R + 50R      | 60R + 60R      | 71R + 71R       |
|---|---------------------------|--------------|---------|----------------|----------------|----------------|----------------|----------------|----------------|-----------------|
| Cooling capacity                          | Min./Nom./Max.            |              |         | 1.30/2.00/2.60 | 1.30/2.50/3.20 | 1.40/3.40/4.00 | 1.70/4.20/5.00 | 1.70/5.00/6.00 | 1.70/6.00/7.00 | 2.30/7.10/8.50  |
| Heating capacity                          | Min./Nom./Max.            |              |         | 1.30/2.50/3.50 | 1.30/2.80/4.70 | 1.40/4.00/5.20 | 1.70/5.40/6.00 | 1.70/5.80/7.70 | 1.70/7.00/8.00 | 2.30/8.20/10.20 |
| Power input                               | Cooling                   | Nom.         |         | 0.44           | 0.56           | 0.80           | 0.97           | 1.36           | 1.77           | 2.34            |
|   | Heating                   | Nom.         |         | 0.50           | 0.56           | 0.99           | 1.31           | 1.45           | 1.94           | 2.57            |
| Space cooling                             | Energy efficiency class   |              |         | A+++           |                |                | A++            |                |                |                 |
|   | Capacity                  | Pdesign      | kW      | 2.00           | 2.50           | 3.40           | 4.20           | 5.00           | 6.00           | 7.10            |
|   | SEER                      |              |         | 8.65           |                |                | 7.85           | 7.41           | 6.90           | 6.20            |
|   | Annual energy consumption |              | kWh/a   | 81             | 101            | 137            | 187            | 236            | 304            | 401             |
| Space heating<br>(Average climate)        | Energy efficiency class   |              |         | A+++           |                | A++            |                | A+             |                |                 |
|   | Capacity                  | Pdesign      | kW      | 2.30           | 2.40           | 2.50           | 4.00           | 4.60           | 4.80           | 6.20            |
|   | SCOP/A                    |              |         | 5.10           |                | 4.71           | 4.71           | 4.30           | 4.10           |                 |
| Nominal efficiency                        | Annual energy consumption |              | kWh/a   | 631            | 659            | 686            | 1,189          | 1,368          | 1,562          | 2,117           |
|   | EER                       |              |         | 4.57           | 4.50           | 4.23           | 4.33           | 3.68           | 3.39           | 3.03            |
|   | COP                       |              |         | 5.00           |                | 4.04           | 4.12           | 4.00           | 3.61           | 3.19            |
|   | Annual energy consumption |              | kWh     | 219            | 278            | 402            | 485            | 679            | 885            | 1,172           |
| Energy labeling Directive Cooling/Heating |                           |              |         | A/A            |                | -/A            | A/A            |                | B/D            |                 |

| Indoor unit          |                         | C/FTXM                    | CTXM15R                           | 20R                  | 25R              | 35R              | 42R              | 50R              | 60R                 | 71R                 |                     |
|----------------------|-------------------------|---------------------------|-----------------------------------|----------------------|------------------|------------------|------------------|------------------|---------------------|---------------------|---------------------|
| Dimensions           | Unit                    | HeightxWidthxDepth        | mm                                | 295x778x272          |                  |                  |                  | 299x998x292      |                     |                     |                     |
| Weight               | Unit                    |                           | kg                                | 10.0                 |                  |                  |                  | 14.5             |                     |                     |                     |
| Air filter           | Type                    |                           |                                   | Removable / washable |                  |                  |                  |                  |                     |                     |                     |
| Fan                  | Air flow rate           | Cooling                   | Silent operation/ Low/Medium/High | m <sup>3</sup> /min  | 4.3/5.7/7.5/10.5 | 4.1/5.7/7.6/10.5 | 4.2/6.0/7.8/11.3 | 4.3/6.5/9.0/11.9 | 8.3/11.4/14/15.8    | 9.1/11.8/14/16.7    | 10.0/12.2/15/16.9   |
|                      |                         | Heating                   | Silent operation/ Low/Medium/High | m <sup>3</sup> /min  | 5.1/6.2/8.2/9.3  | 4.9/6.3/8.0/9.8  | 4.9/6.5/8.5/9.8  | 4.9/6.5/9.7/12.4 | 10.5/12.0/14.2/15.8 | 11.1/12.4/15.2/16.5 | 11.6/12.7/15.8/17.7 |
| Sound power level    | Cooling                 |                           | dBa                               | 57                   |                  | 58               |                  | 60               | 58.0                | 60.0                |                     |
|                      | Heating                 |                           | dBa                               | 54                   |                  | 60               |                  | 60               | 58.0                | 59.0                | 61.0                |
| Sound pressure level | Cooling                 | Silent operation/Low/High | dBa                               | 19/25/41             |                  | 19/29/45         |                  | 21/30/45         | 27.0/36.0/44.0      | 30.0/37.0/46.0      | 32.0/38.0/47.0      |
|                      | Heating                 | Silent operation/Low/High | dBa                               | 20/26/39             | 20/27/39         | 20/28/39         | 21/29/45         | 31.0/34.0/43.0   | 33.0/36.0/45.0      | 34.0/37.0/46.0      |                     |
| Control systems      | Infrared remote control |                           |                                   | ARC466A67            |                  |                  |                  |                  |                     |                     |                     |
|                      | Wired remote control    |                           |                                   | BRC073A1             |                  |                  |                  |                  |                     |                     |                     |

| Outdoor unit         |                               | RXM                | CTXM15R                | 20R                                    | 25R | 35R        | 42R         | 50R        | 60R  | 71R         |      |
|----------------------|-------------------------------|--------------------|------------------------|--|-----|------------|-------------|------------|------|-------------|------|
| Dimensions           | Unit                          | HeightxWidthxDepth | mm                     | 550x765x285                            |     |            | 734x870x373 |            |      | 734x954x401 |      |
| Weight               | Unit                          |                    | kg                     | 32                                     |     |            | 49.0        |            |      | 55          |      |
| Sound power level    | Cooling                       |                    | dBa                    | 59                                     | 58  | 61         | 62.0        |            | 63.0 | 66.0        |      |
|                      | Heating                       |                    | dBa                    | 59                                     |     | 61         | 62.0        |            | 63.0 | 67.0        |      |
| Sound pressure level | Cooling                       | Nom.               | dBa                    | 46                                     |     | 49         | 48.0        |            |      | 47.0        |      |
|                      | Heating                       | Nom.               | dBa                    | 47                                     |     | 49         | 48.0        | 49.0       | 48.0 |             |      |
| Operation range      | Cooling                       | Ambient            | Min.~Max.              | -10~-50°C                              |     |            |             |            |      |             |      |
|                      | Heating                       | Ambient            | Min.~Max.              | -20~-25°C                              |     |            |             |            |      |             |      |
| Refrigerant          | Type                          |                    |                        | R-32                                   |     |            |             |            |      |             |      |
|                      | GWP                           |                    |                        | 675                                    |     |            |             |            |      |             |      |
| Piping connections   | Charge                        |                    | kg/TCO <sub>2</sub> Eq | 0.76/0.52                              |     | 1.10/0.750 |             | 1.15/0.780 |      |             |      |
|                      | Liquid                        | OD                 | mm                     | 9.50                                   |     |            | 6.35        |            | 12.7 |             | 15.9 |
|                      | Gas                           | OD                 | mm                     | 20                                     |     |            |             |            | 30   |             |      |
|                      | Piping length                 | OU - IU            | Max.                   | 10                                     |     |            |             |            |      |             |      |
|                      | Additional refrigerant charge | System             | Chargeless             | 0.02 (for piping length exceeding 10m) |     |            |             |            |      |             |      |
|                      | Level difference              | IU - OU            | Max.                   | 15                                     |     |            |             |            | 20.0 |             |      |
| Power supply         | Phase/Frequency/Voltage       |                    |                        | 1~/50/220-240                          |     |            |             |            |      |             |      |
| Current - 50Hz       | Maximum fuse amps (MFA)       |                    |                        | -                                      |     |            |             |            |      |             |      |

See separate drawing for operation range | See separate drawing for electrical data | Nominal cooling capacities are based on: indoor temperature: 27°CDB, 19°CWB, outdoor temperature: 35°CDB, equivalent refrigerant piping: 5m, level difference: 0m. | Nominal heating capacities are based on: indoor temperature: 20°CDB, outdoor temperature: 7°CDB, 6°CWB, equivalent refrigerant piping: 5m, level difference: 0m. | Cooling: indoor temp. 27°CDB, 19.0°CWB; outdoor temp. 35°CDB, 24°CWB; equivalent piping length: 5m | Heating: indoor temp. 20°CDB; outdoor temp. 7°CDB, 6°CWB; equivalent refrigerant piping: 5m | Contains fluorinated greenhouse gases

# Multi split Less is more!

A Daikin multi split system offers you unexpected possibilities in creating a comfortable and cosy home. This is your solution to reduce limitations like environmental impact and financial aspects.

## Less mounting space, less visibility, less sound

- › **Save space:** drastically reduce the space required for placing a number of units on your facade
- › **Less visibility:** enjoy your nice ambience. Finding just one hiding place is much easier
- › **Less noise:** only one unit in operation is much quieter than two or more units

## Easier installation, wiring, piping and maintenance

- › **Save mounting equipment:** Wherever you want to place an outdoor unit, for every unit you will need a mounting for a secure fixing and problem-free operation
- › **Save time:** the physical installation, wiring, drain piping as well as the initial setup of only one system is much easier and faster
- › When using only one outdoor unit instead of two or more, the statistical probability of a **possible technical defect is reduced** with every unit that you do not need

## Lower power consumption, high efficiency

- › **Less power consumption:** our big compressors can work more efficiently than various smaller ones with the same capacity in sum. Also save a significant proportion of energy thanks to standby mode

## More flexibility: connect up to 5 indoor units of any style

There are many possibilities in comfort you can profit from a multi split solution:

- › **Up to 5 indoor units** connectable to only one outdoor unit
- › Every single indoor unit can be **regulated separately**
- › Choose from **a greater variety** of connectable indoor unit types out of our split and Sky Air series
- › Use low capacity indoor units specially **designed for small rooms** which can only be connected to a multi split system
- › Are you planning an **additional indoor unit later on?** Just decide now for an outdoor unit with higher capacity and simply connect it later

Pair split or multi split combination – the direct system comparison

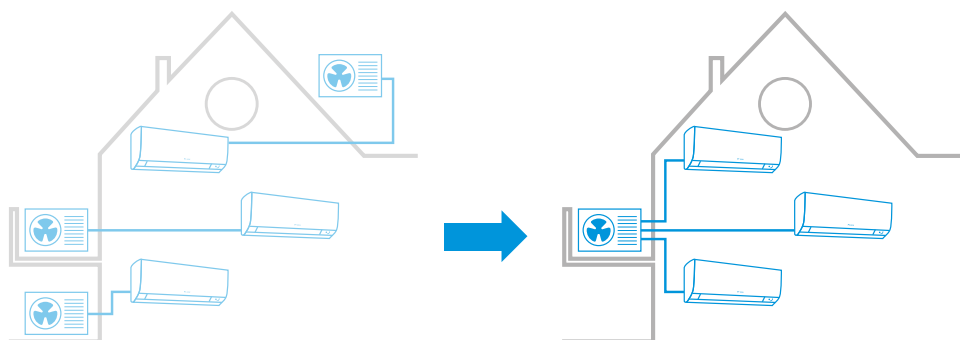

Conventional pair split installation for air-conditioning three rooms

Solution for the same situation with only one multi split outdoor unit

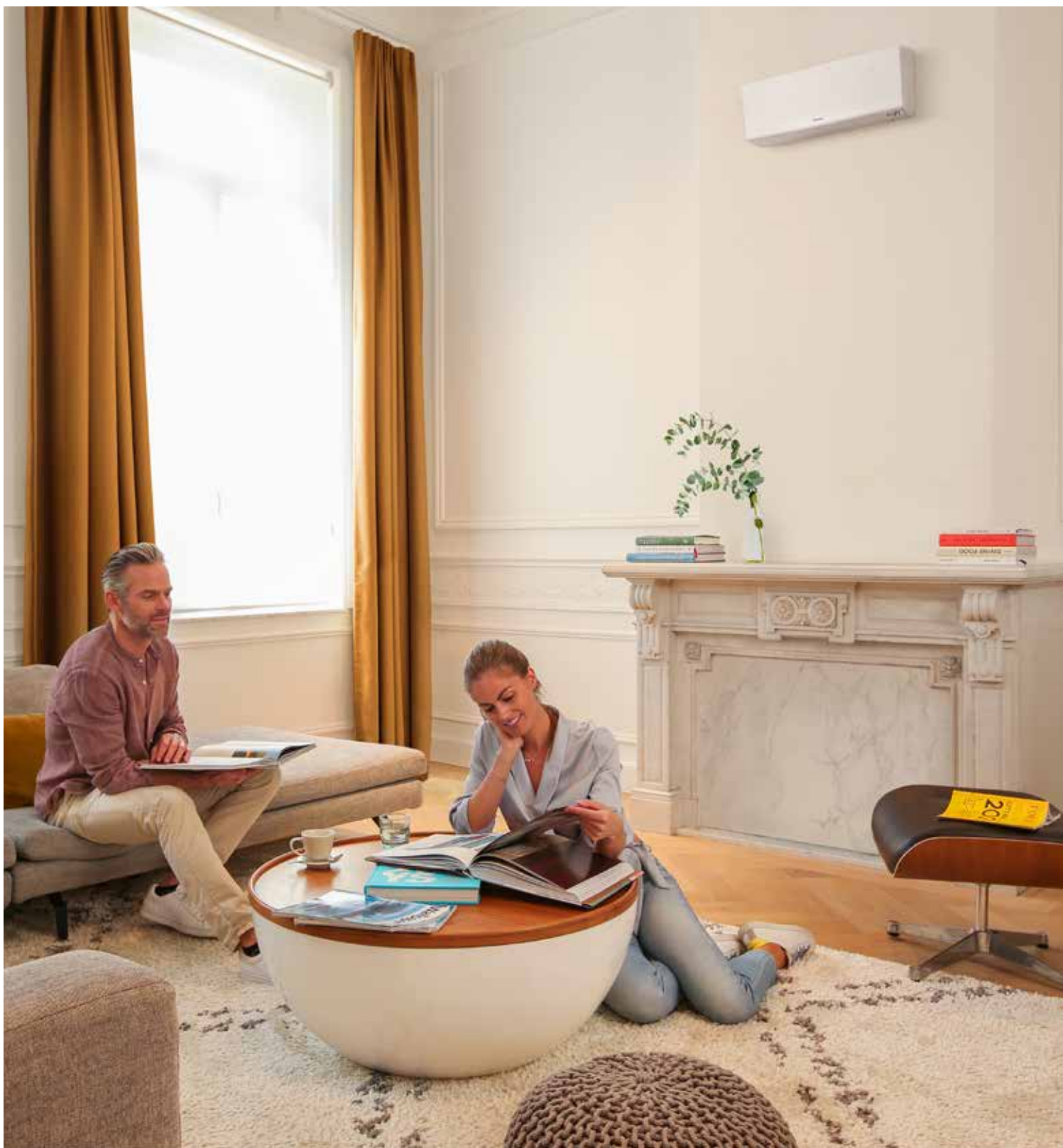

[www.daikin.eu](http://www.daikin.eu)

**Daikin Europe N.V.** Naamloze Vennootschap Zandvoordestraat 300 · 8400 Oostende · Belgium · [www.daikin.eu](http://www.daikin.eu) · BE 0412 120 336 · RPR Oostende (Publisher)



ECPEN20-008

10/2020



The present publication is drawn up by way of information only and does not constitute an offer binding upon Daikin Europe N.V. Daikin Europe N.V. has compiled the content of this publication to the best of its knowledge. No express or implied warranty is given for the completeness, accuracy, reliability or fitness for particular purpose of its content and the products and services presented therein. Specifications are subject to change without prior notice. Daikin Europe N.V. explicitly rejects any liability for any direct or indirect damage, in the broadest sense, arising from or related to the use and/or interpretation of this publication. All content is copyrighted by Daikin Europe N.V.

Printed on non-chlorinated paper. Designed by La Movida.